

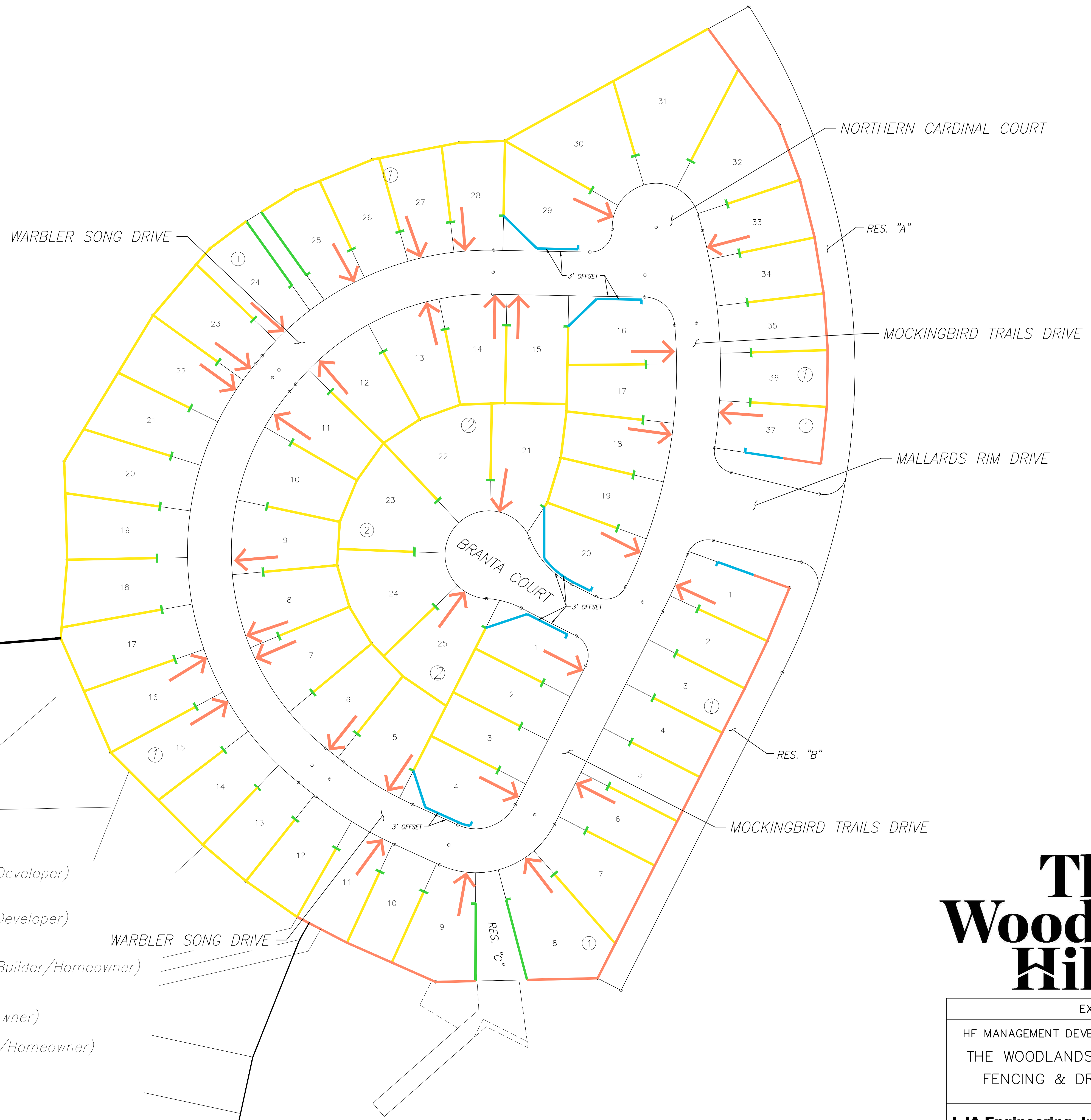







N  
SCALE: 1"=60'



**LEGEND**

-  7' GOOD SIDE OUT FENCE WITH ROT BOARD AND CAPPED (To Be Installed By Developer)
-  6' DOUBLE SIDED FENCE WITH ROT BOARD AND CAPPED (To Be Installed By Developer)
-  6' GOOD SIDE OUT FENCE WITH ROT BOARD AND CAPPED (To Be Installed By Builder/Homeowner)
-  6' GOOD NEIGHBOR FENCE WITH ROT BOARD (To Be Installed By Builder/Homeowner)
-  5' TUBE METAL FENCING (To Be Installed By Builder/Homeowner)
-  45-DEGREE ANGLED FENCE
-  LOCATION OF DRIVEWAY
-  RETAINING WALL (To Be Installed By Developer)

\*Note: The intent of the driveway designation is to avoid conflict with but not limited to: streetlights, manholes, large inlets, radius of curbs, intersections, corners and neighborhood entrances.  
\*Note: Fence repair and maintenance are the responsibility of the property owner, not the installer.

# The Woodlands Hills

EXHIBIT

HF MANAGEMENT DEVELOPMENT COMPANY, LLC  
THE WOODLANDS HILLS SECTION 37  
FENCING & DRIVEWAY EXHIBIT

**LJA Engineering, Inc.**  
480 Wildwood Forest Dr  
Suite 250  
Spring, Texas 77380

Phone 713.953.5200  
Fax 713.953.5026  
FRN - F-1386

Date: 2/14/24 SHEET NO. 1 OF 1

Date/Time : Wed, 14 Feb 2024 - 7:21am  
Path/Name : I:\Project\674\0200\EXHIBITS\FENCING\TWR SEC 37 Fencing Exhibit.dwg